

OREGON PUBLIC LAND CORNER REPORT / RESTORATION REPORT  
Tillamook County Surveyor's Office

|  |                          |   |
|--|--------------------------|---|
| <b>SECTION:</b> 26 & 35  | <b>TOWNSHIP:</b> 3 North | <b>RANGE:</b> 10 West                                     |
| <b>COUNTY:</b> Tillamook   |                          | <b>DATE:</b> 10/1/2022                                    |
| <b>CORNER DESIGNATION:</b><br>Quarter corner common to sections 26 and 35 Township 3 North, Range 10 West<br>Willamette Meridian |                          | <b>(Please check one)</b>                                 |
|  |                          | <input checked="" type="checkbox"/> Condition Report Only |
|  |                          | <input type="checkbox"/> Restoration                      |
|  |                          | <input type="checkbox"/> Rewitness                        |
|  |                          | <input type="checkbox"/> Unrecorded                       |
|  |                          | <input type="checkbox"/> Reset at surface                 |
|  |                          | <input type="checkbox"/> Referenced Out                   |

**Previous Rewitnesses, Restorations and Surveys, etc...** G.L.O. 3N 10W pg. 18 (1873), Field Bk. P16 pg. 4 (1915), Note Bin 3N Sect. 26 Golden West (1923), A-166, B-74 (1923), A-208 (1927), B-161 (1949), A-510 (1952), B-626 (1972), B-736 (1976), A-3095 (1977), A-3380 (1977), Rewitness Card #140 (1979), P-235 (1994), B-3269 (2008), B-4052 (2020), B-4112 (2021)

**History, condition, and sources:** In 1873 under G.L.O. contract #183 C.J. Handley D.S. set a wood post for the ¼ corner and gave the corner 2 bearing tree references. Beginning in 1927 with Map A-208 and up to Rewitness card #140 (1979) a stone was used as the corner but no other references other than the G.L.O. references were added. In 1979 Tillamook County Surveyors office set a 2" iron pipe with a 3" Tillamook County brass cap stamped as shown hereon in 10" tile and concrete and added 3 new accessories. In 2022 the Tillamook County Survey office visited the corner and found the cap as shown hereon in good condition but with only one existing accessory the hat section post with yellow metal location tag.

Not Found: (Rewitness card #140) 30" Spruce South 7.0' gone  
 Not Found: (Rewitness card #140) 10" post North .60' gone replaced with new post now East 1.5'  
 Found: (Rewitness card #140) Hat section post with yellow metal location tag 1.5' East.

**New accessories set:**

Found: 6" round wood fence post 1.5' East

The Monument was tied directly using G.P.S. established control. The coordinates have been converted and are provided here in WGS 84, Latitude and Longitude.

Latitude: 45° 42' 38.06"  
 Longitude: - 123° 52' 26.52"

**Pictures of Found Monuments:**

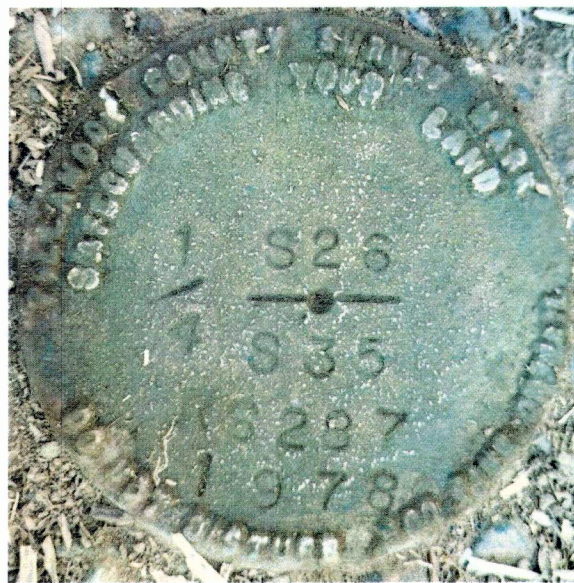

**Location:** This Corner is located on the east side of a gateway of a North- West-East running fence 1.5' West of corner post of North-West - East running fence; ±370' north of slough.

**Tillamook County Surveyor office:** 1510 3<sup>rd</sup> Street Suite C, Tillamook, OR. 97141

**Party Chief:** Michael Rice P.L.S. 86926, Tillamook County Surveyor

**Witnesses:** Travis Porter, Survey Supervisor

**Notes:** Digital images taken of monument and accessories.

**SURVEYOR'S SEAL**

REGISTERED  
 PROFESSIONAL  
 LAND SURVEYOR

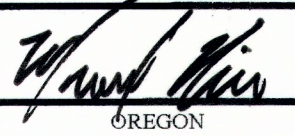

OREGON  
 DECEMBER 11, 2012  
 MICHAEL R. RICE  
 86926  
 RENEWAL 12-31-2022

